

OFFICE COPY

13/01/118-A/e 2003  
 Planning Permit No. **APPROVED**  
 SUBJECT TO THE ORDINANCES OF THIS OFFICE  
 No. B2/28416/B3 19-3-2003  
 FOR METRO WATER  
 CHENNAI WATER DEVELOPMENT AUTHORITY  
 CHENNAI-600 008.

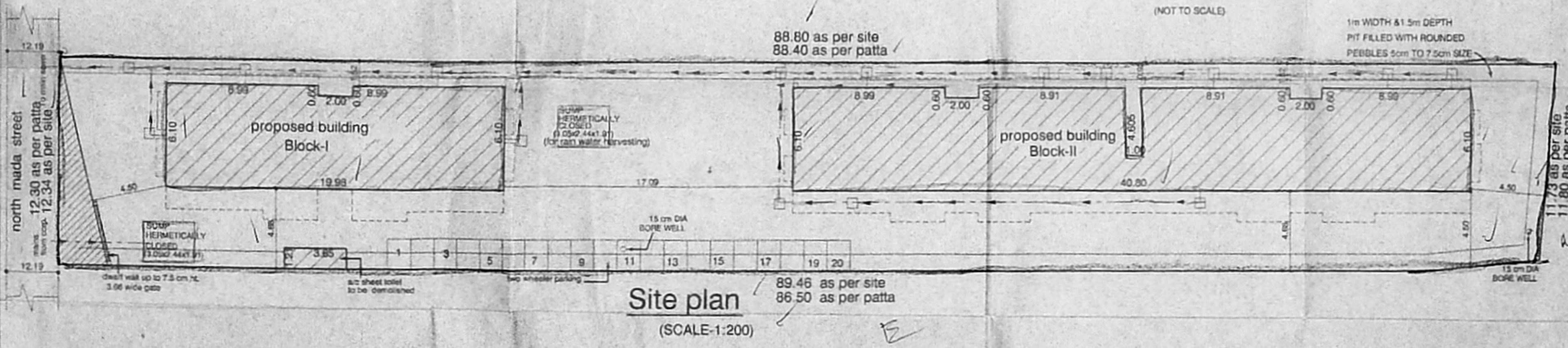
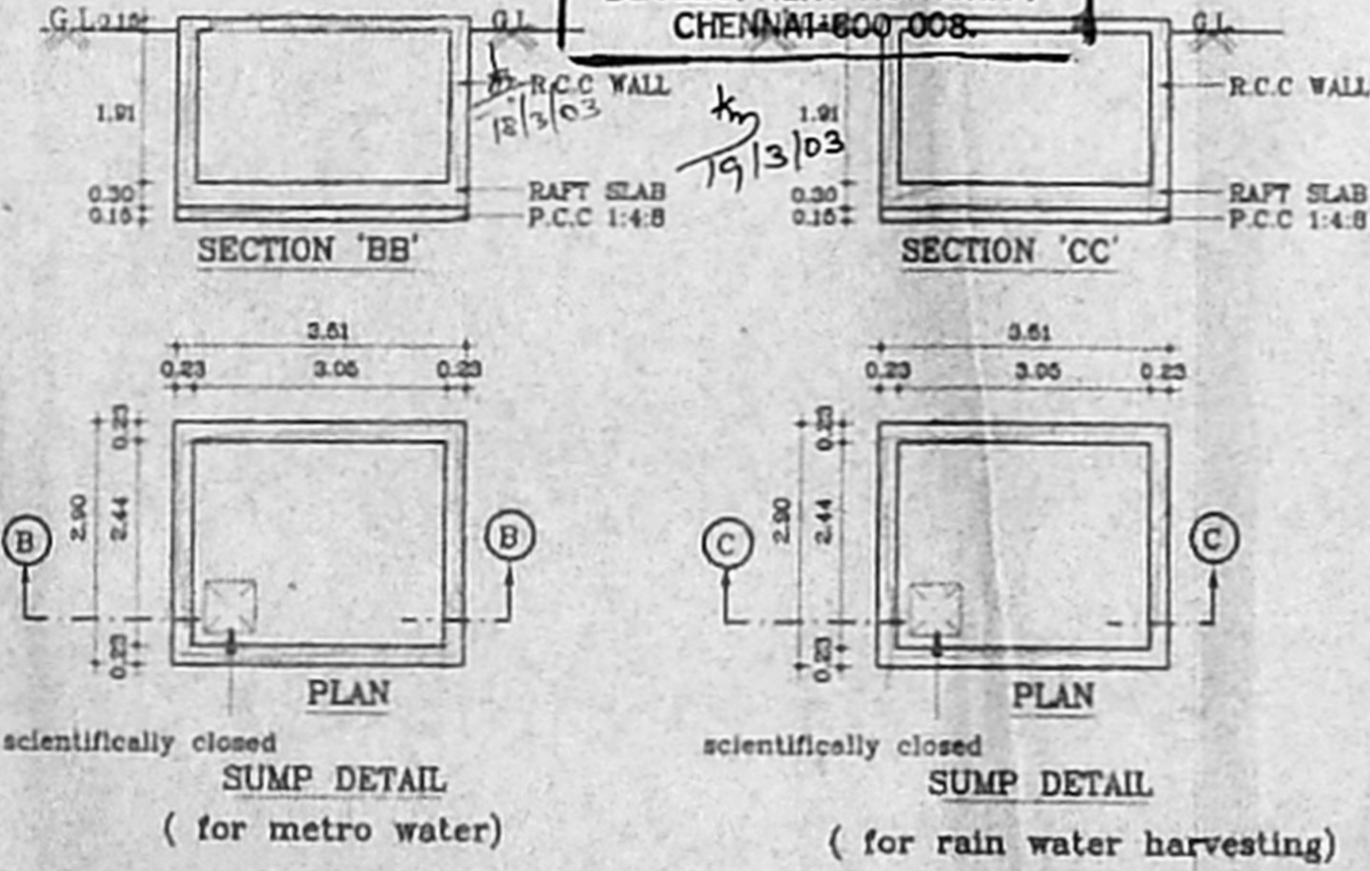
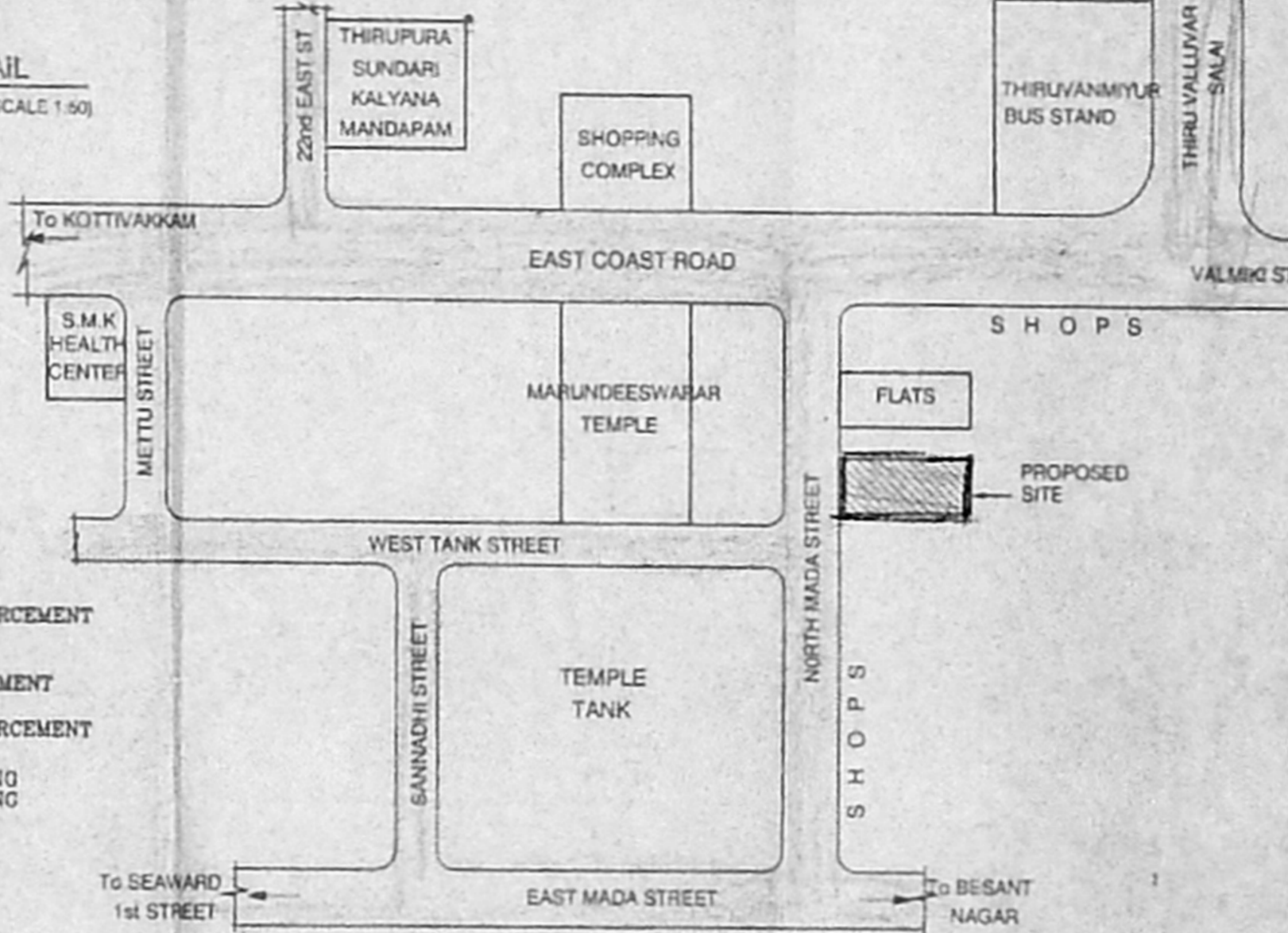
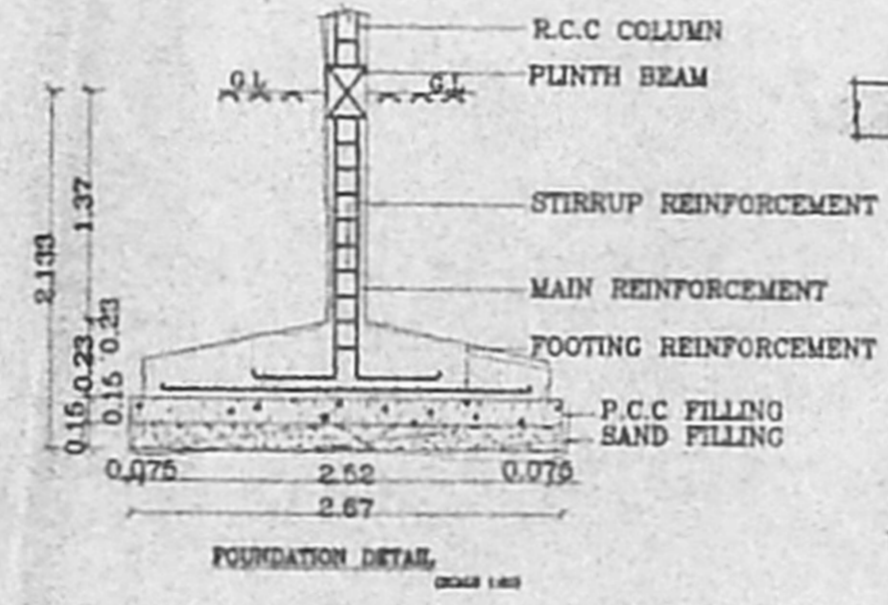
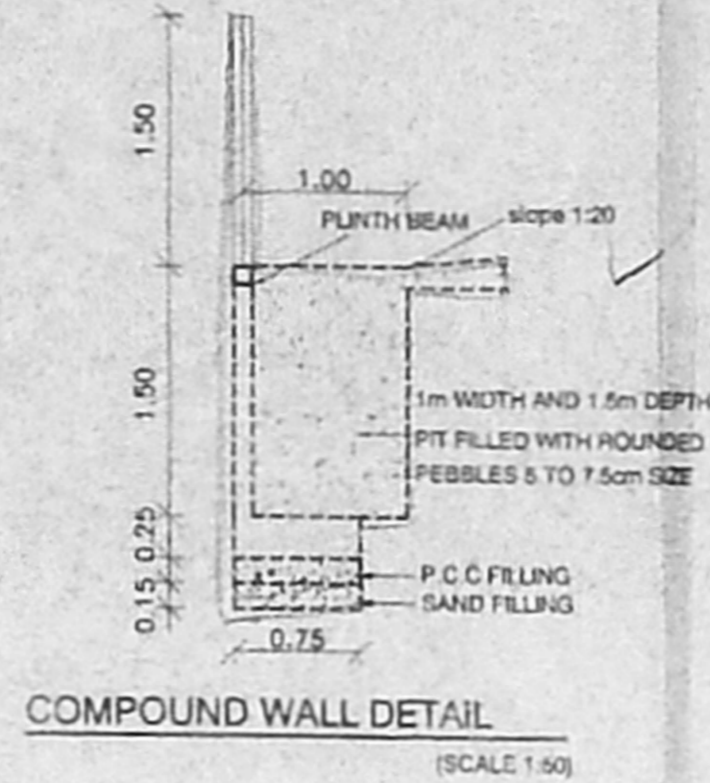

AREA STATEMENTS	SQ.M
PLOT AREA(as per patta )	1018.00
PLOT AREA(as per document)	1011.71
<b>BLOCK-I</b>	
GROUND FLOOR AREA	120.88
FIRST FLOOR AREA	164.05
SECOND FLOOR AREA	164.05
THIRD FLOOR AREA	164.05
<b>BLOCK-I TOTAL AREA</b>	<b>612.83</b>
<b>BLOCK-II</b>	
GROUND FLOOR AREA	328.60
FIRST FLOOR AREA	328.60
SECOND FLOOR AREA	328.60
<b>BLOCK-II TOTAL AREA</b>	<b>985.80</b>
<b>TOTAL AREA</b>	<b>1510.41</b>
F.S.I.	1.493
PLOT COVERAGE	48.69 %

PROPOSED RESIDENTIAL FLATS AT NEW DOOR No:27,NORTH MADA STREET, THIRUVANMIYUR,CHENNAI-600041. COMPRISED IN T.S No:159/2, BLOCK NO:45/OF THIRUVANMIYUR VILLAGE IN CHENNAI CORPORATION DIVISION No:155.

SCALE : 1:100      DATE : 25.02.2003  
 JOB NO : 813      DRAWN : A.Sheela

SHEET No-1/3  
 COLOUR INDEX  
 PROPOSED ROAD:   
 BOUNDARY:   
 SEWER LINE:

For S & S Foundations Private Ltd.  
  
 APPLICANT SIGNATURE

ARCHITECT  
 R.SATHYANARAYANA, b.arch. a.i.a.

R. SATHYANARAYANA, B.Arch. A.I.A.  
 REGISTERED ARCHITECT  
 R.A.No: 97  
 No: 55 (OLD U-12) 4th MAIN ROAD,  
 ANNA NAGAR, CHENNAI-600 040.

67.00  
 47.00

10:00  
8:50:50

SCHEDULE OF JOINERY		
TYPE	DESCRIPTION	SIZE
D	DOOR	1.00x2.13
D1	DOOR	0.90x2.13
D2	DOOR	0.76x2.13
W	WINDOW	1.83x1.37
W1	WINDOW	1.22x1.37
KW	KITCHEN WINDOW	0.90x0.90
V	VENTILATOR	Revised 1.40
F/W	French Window	2.13x2.13
R/S	Rolling Shutter	

- SPECIFICATIONS :-**
- R.C.C FOOTING, COLUMN IN CONCRETE 1:2
  - SUPER STRUCTURE REINFORCED IN CONCRETE
  - R.C.C 1:2:4 FOR LINTEL, SLAB, STAIRS
  - P.C.C 1:4:8 FOR FLOOR, TERRACE COURSE
  - P.C.C 1:4:8 IN BASEMENT FOR FOUNDATION
  - JOINERY WITH T.W FLUSH DOORS, T.W GLAZED WINDOWS & VENTILATORS
  - 3 COATS OF CEMENT PAINT TO INSIDE & OUTSIDE WALLS
  - 2 COATS OF ENAMEL PAINTS OVER ONE COAT OF PRIMER FOR JOINERY, GRILLS ETC
  - WEATHERING COURSE OVER ROOF SLAB 3" THICK WITH BRICK JELLY CONCRETE AND ONE LAYER OF PRESSED TILES ON TOP.

AREA STATEMENTS	SQ.M
AS PER PATTI	1018.00
AS PER DOCUMENT	1011.71
<b>BLOCK-I</b>	
GROUND FLOOR AREA	120.68
FIRST FLOOR AREA	164.05
SECOND FLOOR AREA	164.05
THIRD FLOOR AREA	164.05
<b>BLOCK -I TOTAL AREA</b>	<b>612.83</b>

PROPOSED RESIDENTIAL FLATS AT NEW DOOR No:27,NORTH MADA STREET, THIRUVANMIYUR,CHENNAI-600041. COMPRISED IN T.S No:159/2, BLOCK NO:45 OF THIRUVANMIYUR VILLAGE IN CHENNAI CORPORATION DIVISION No:155.

SCALE : 1:100	DATE 8:01:2003
JOB NO : 613	DRAWN : R.M

SHEET No:2/3

COLOUR INDEX

PROPOSED

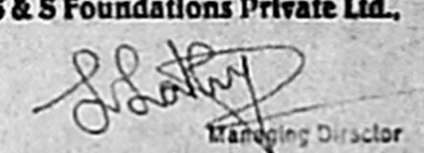
For S & S Foundations Private Ltd.  
  
 Managing Director  
 APPLICANT SIGNATURE

ARCHITECT  
**R.SATHYANARAYANA, b.arch. a.i.a.**

*R. Sathy Narayana*  
 R. SATHYANARAYANA, B.Arch. A.I.A.  
 REGISTERED ARCHITECT  
 R. A. No: 97  
 NO: 55 (OLD U-12) 4th MAIN ROAD,  
 ANNA NAGAR, CHENNAI-600 029

